

Please Select From The Below Options, For Sign Or Signage That Will Work Best For Your Individual Property.

Option A Face Insert With Wood Frame

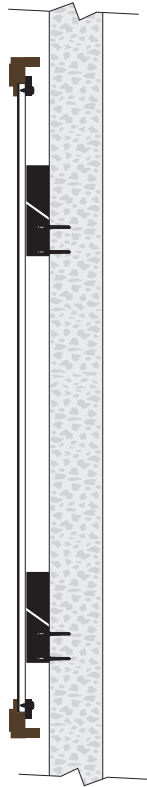

Menu Sign With Customized Copy  
\$1,683.00 Size: 32" W x 52" H  
Menu Sign, Mounted To Wall With Brackets

Provide Menu Items To Be Listed For Your Specific Location

---

---

---

---

---

---

---

---

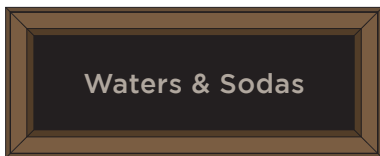

Station Descriptions Signs  
\$685.00 Each Size: 20" W x 8" H  
Menu Sign, Mounted Flush To Wall

Please Select Which Station Descriptions Your Property Will Need

- Water & Soda  Juice & Yogurts  Beer & Wine  
 Frozen Sweets  Salads & Sandwiches

Option B Face Insert With Stand-Offs

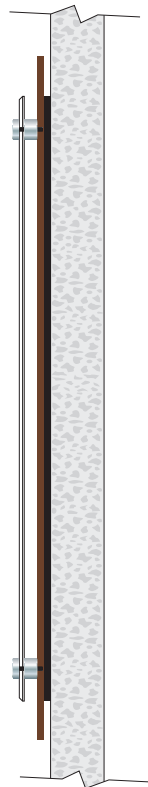

Menu Sign With Customized Copy  
\$1,088.00 Size: 32" W x 52" H  
Menu Sign, Mounted Flush To Wall

Provide Menu Items To Be Listed For Your Specific Location

---

---

---

---

---

---

---

---

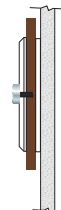
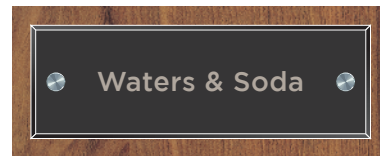

Station Descriptions Signs  
\$171.00 Each Size: 20" W x 8" H  
Menu Sign, Mounted Flush To Wall

Please Select Which Station Descriptions Your Property Will Need

- Water & Soda  Juice & Yogurts  Beer & Wine  
 Frozen Sweets  Salads & Sandwiches

Please Select From The Below Options, For Sign Or Signage That Will Work Best For Your Individual Property.



Small Logo Sign  
\$327.00 Size: 20" W x 16" H  
Note: This Matches Option B Style From Page 1  
Logo Sign, Mounted Flush To Wall

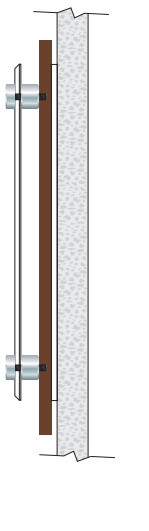

Install View  
Note: Install Placement Will Vary Per Location



Vinyl Logo  
\$36.00 Standard Size: 18" W x 9" H  
Note: Properties Can Have Custom Sized Logo  
Surface Application- Install On Glass

Custom Sized Logo  
Please Provide Measurements Of Glass  
Or Area Where Logo Will Be Installed  
\_\_\_\_\_ " W x \_\_\_\_\_ " H

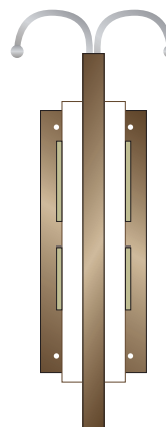

Double Sided Logo  
Projection Mount Sign  
\$3,861.00  
Size: 39-3/4" W x 19-3/4" H  
Projection Mount, Mounted To Corridor Wall Or Column

**Return to:**

Amy Scheer  
313 Ida Wichita, KS 67211  
316-267-4171 (phone)  
316-267-6883 (fax)  
amy.scheer@identitygroup.com

You will receive a  
quote once we receive  
your completed order form.

**Ordering Information:**

Contact Name & Phone Number:  
\_\_\_\_\_  
Company Name:  
\_\_\_\_\_  
Billing Address:  
\_\_\_\_\_  
\_\_\_\_\_  
\_\_\_\_\_  
Email Address:  
\_\_\_\_\_

**Shipping Information: (If Different Than Order Information)**

Contact Name & Phone Number At Property:  
\_\_\_\_\_  
Property Name:  
\_\_\_\_\_  
Shipping Address:  
\_\_\_\_\_  
\_\_\_\_\_  
\_\_\_\_\_

**NOTE: PRICE INCLUDES PRODUCT ONLY**  
Quote Will Be Sent With Final Total, Crating, Shipping\* & Tax Before Order Is Placed.  
\*Shipping Charges are based upon weight & ZIP code. A total is determined when the order ships.