

1 Hilton Lobby Level Floor Plan - Area A
1/8" = 1'-0"

- GENERAL NOTES**
- REFERENCE VOLUME #10 (TYPICAL ARCHITECTURAL DETAILS) SHEET NUMBERS A4-00 AND A4-01 FOR TYPICAL PARTITION LEGENDS.
 - REFERENCE A7-01 THROUGH A7-04 SHEETS IN VOLUMES 3A, 5A AND 7A FOR SPECIFIC BUILDINGS' DOOR SCHEDULES.
 - REFERENCE VOLUME #10 (TYPICAL ARCHITECTURAL DETAILS) SHEET NUMBER A7-04 FOR LOUVER SCHEDULES.
 - INDICATES RISING DIRECTION OF ANGLED BRACED FRAME AT CONVENTION CENTER.
 - FOR SLAB DEPRESSION DIMENSIONS SEE (E.O.S.) EDGE OF SLAB DRAWINGS.
 - REFERENCE VOLUME #10 (TYPICAL ARCHITECTURAL DETAILS) SHEET NUMBER A4-02 FOR SHOWER & TUB DETAILS AT GUESTROOMS.
 - PROVIDE BLOCKING IN WALLS AT SHOWERS AND TUBS AS REQUIRED.
 - SEE I.D. DRAWINGS AND ELECTRICAL DRAWINGS FOR ELECTRICAL OUTLET LOCATIONS. OFFSET BACK-TO-BACK OUTLETS WITH (1) STUD WIDTH MINIMUM BETWEEN OUTLETS.
 - WHERE TUB/SHOWERS HAVE (1L1) WALL TYPE ON CORRIDOR, LOCATE (2) LAYERS OF DRYWALL ON UNIT SIDE OF PARTITION TYPE.
 - SEE PLUMBING DRAWINGS FOR FLOOR DRAIN LOCATIONS AT ROLL-IN-SHOWER UNITS.
 - GUESTROOM WATER CLOSETS ARE TO BE CENTERED 1'-6" FROM FINISHED WALL.

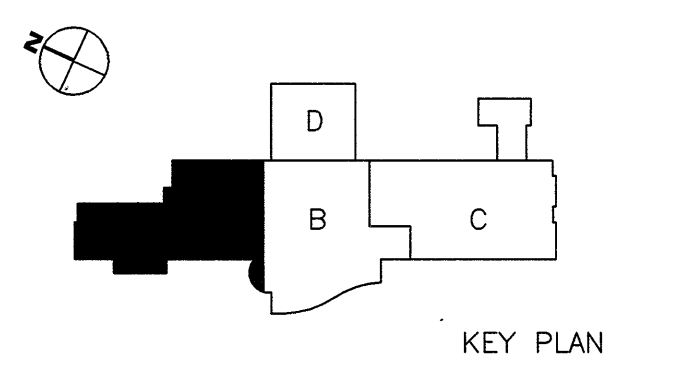

Smallwood, Reynolds, Stewart & Associates, Inc. Architects FL LIC. #AA0002800

HILTON LOBBY LEVEL FLOOR PLAN - AREA A

BONNET CREEK RESORT
Orlando, Florida
Bonnet Creek Venture

Hilton
Bonnet Creek
KIP International LLC

DATE: 07/06/07
DRAWN: []
CHECKED: []
JOB NO.: AH1-02A

REVISIONS

NO.	REMARKS
1	AS1 #1
2	AS1 #3 11/21/07
3	AS1 #4 07/11/08
4	AS1 #7 05/08/09

PRINTED

DATE	REMARKS
03/31/06	SCHEMATIC DESIGN V.E.
05/31/06	DD PROGRESS PRINT
06/30/06	SOC. DO ISSUE
08/31/06	DD ISSUE
09/15/06	GMP ISSUE
10/16/06	FOUNDATION PERMIT
12/12/06	FOUND. PERMIT REV. 1
12/26/06	BLDG. PERMIT ISSUE
12/30/06	PROGRESS PRINTING
03/19/07	BLDG. PERMIT RESPONSE
05/31/07	OWNER'S REVIEW SET
06/08/07	ISSUED AS CAD FILES
07/06/07	ISSUED FOR CONSTRUCTION
08/31/07	AS1 #1
05/08/09	AS1 #7

RECORD SET
JULY 31, 2009

One Piedmont Center, Suite 303 3565 Piedmont Road Atlanta, Georgia 30305 TEL. 404-238-5463